



DESCRIPTION

- These wipes are the latest innovation in combating graffiti.
- Powerful cleaning formula removes tough graffiti, including enamel.
 - Abrasive yet non-scratching fabric aids in cleaning.
 - Does not contain amyl acetate or methylene chloride, making towels safer to handle.
 - Biodegradable formula.
 - Towels stay moist to provide greater usage and longer shelf life.

USE ON A VARIETY OF HARD SURFACES INCLUDING:

- Bathroom Partitions • Phone Booths • Lamp Posts • Desks • Bus Stops & Seats • Wall Tile • Trains • Aluminum Siding • Road Signs • Stainless Steel • Billboards • Lockers
- Removes graffiti from almost any hard surface!

IDEAL FOR SCHOOLS, BUSINESSES & MUNICIPALITIES

- Street & Sign Crews • Park & Rec Departments • School Districts • Sports Facilities • Transportation Authorities • Utility & Power Crews

SPECIAL NOTE: When using on a pre-painted surface, initially test in an inconspicuous area to make sure paint is not removed along with the graffiti. These wipes may degrade certain plastics.

Wash thoroughly after handling.

Wear eye protection, protective clothing, protective gloves.

IF IN EYES: Rinse cautiously with water for several minutes. Remove contact lenses, if present and easy to do. Continue rinsing.

If eye irritation persists: Get medical advice/attention

In case of fire: Use dry extinguishing powder, foam, carbon dioxide (CO₂) to extinguish.

Dispose of contents/container to comply with local/regional/national/international regulations. Do not flush wipes.

For industrial and commercial use only.

For additional information, see Safety Data Sheet.

AE 050

GRAFFITI WIPES

REMOVES GRAFFITI AND PAINT IN ONE EASY STEP

- ABRASIVE TOWEL AND HIGHLY-EFFECTIVE FORMULA



KEEP OUT OF REACH OF CHILDREN

WARNING

Causes serious eye irritation.

See side panel for additional safety information.

NET CONTENTS: **40**

9.5" x 12" (24.13 cm x 30.48 cm) Premoistened Wipes

Sold By:

**ALAN ENVIRONMENTAL
PRODUCTS, INC.**

PO Box 934 • Monmouth, IL 61462

Toll Free: 800-991-3765

Fax: 877-991-3010

www.alanenvironmental.com

DIRECTIONS

Protective gloves are recommended while using this product. Unfold a towel and lightly scrub in a circular motion to begin dissolving paint and graffiti on non-porous surfaces. Wipe up any remaining residue with a clean cloth. Continue to use a clean part of towel for best results. Discard towel after use.

DIRECTIONS FOR DISPENSING

1. Remove lid by lifting upward. Remove foil seal.
2. Pull towel from center of the roll and thread through "X" on the underside of the lid.
3. Close lid. Pull towel at 90° angle.
4. Snap hinged cap back into place to ensure towels stay moist.

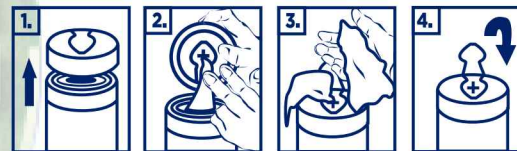

NFPA® Ratings

Health: 1; Flammability: 2; Reactivity: 0

Contains/CAS Number:

Dimethyl Glutarate/1119-40-0; Methyl Ester of Soybean Oil/67784-80-9; Ethyl Lactate/97-64-3; Dimethyl Succinate/106-65-0; Dimethyl Adipate/627-93-0; Linear Alcohol Ethoxylate/34398-01-1



Please Recycle.

Canister made from 25% post-consumer recycled plastic.

1447.063015